

FLOS

■ F9550030 Black

Wan Ceiling/Wall

Designed by Johanna Grawunder, 2005



Halogen - 40W

Wall or ceiling fixture providing direct lighting. Aluminum body, available in shiny white, shiny black and shiny green finishes. Low glare shield. Provided by two different ring due to block the safety tempered glass, in black and green.

Are you a professional and your project needs consulting and support?

[BOOK AN APPOINTMENT](#)

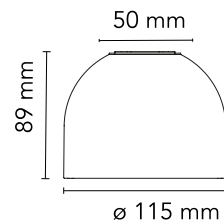

Main specifications

EAN	8059607024188
Mounting	Ceiling and wall surface
Environments	Indoor dry location
Light Source Type	Bulb
Lamp category	Halogen
Lamp holders	G9
Ilcos	HSG
Number of heads	1
Power (W)	40

Physical

Colour	Black
Net weight (kg)	0
Package height (cm)	140
Package width (cm)	140
Package length (cm)	150
IP internal	40

Download

[Mounting instructions](#)  PDF

[Spare Parts](#)  PDF

Photometric Files

[LDT / IES](#)  LDT

Technical Drawings

[2D](#)  ZIP

[3D](#)  ZIP



Schematic light drawing

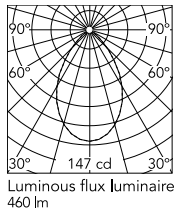

Beam Angle: 68°

h(m)	E(lx)	D(m)
1	147	1.35
2	37	2.70
3	16	4.05
4	9	5.40
5	6	6.75

Photometric

Lighting type	Direct
Light distribution	Symmetric

Electrical

Insulation class	II
Frequency (Hz)	50/60
Main voltage (Vac)	220-250
LED voltage Vf (Vdc)	null
Dimmable	Yes
Dimming interface	Remote Dimmable (Dimmer Not Included)
Batteries inside	No
Charging min time	No

Bulbs



NOT INCLUDED

RF18863

Halogen Lamp G9 33W 2700K

HALOPIN Dimmable

Spare Parts

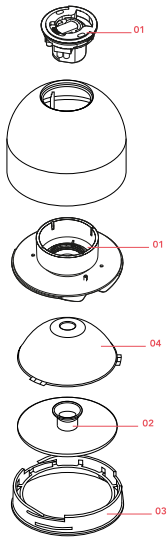

- | | | |
|-----|--|-----------|
| 01. | New type attachment assembly with g9 lamp holder and safety ring | RF9550300 |
| 02. | Wan glass assembly | RF9550200 |
| 03. | External ring | RF13990 |
| 03. | External ring | RF14546 |
| 04. | Reflector / ring assembly | RF9550130 |

DOWNLOAD



RF9550300

New type attachment assembly
with g9 lamp holder and safety
ring



RF9550200

Wan glass assembly



RF13990

External ring



RF14546

External ring



RF9550130

Reflector / ring assembly